



WEEKLY MANSION TOKIWADAI

20120425

Address: 1-52-5, Tokiwadai, Itabashi-ku, Tokyo, Japan 〒174-0071
Phone: 81-3-5392-5001/Fax: 81-3-5392-5028 (Business Hours are between 9 A.M. and 6 P.M.)

Reservations: Contact us at 81-3-3434-3939 (Tel) 81-3-6891-7711 (Fax)
For English, Please contact us between 9 A.M. and 6 P.M. from Mon to Fri.

■ On-Site Pay Services:

- Coin laundries/Driers
- Vending machine (Beverages/ Newspaper)

■ In-Room Services and Amenities:

High-Speed Internet access/ TV
Video-on-Demand
Telephone/ Mini-refrigerator
Air conditioner/ Bed (Exchange of sheets and pillowcases is a chargeable service and on request.)
Table/ Kitchenware and Tableware/ Bathroom/ Hair drier

■ Business Services:

Copying and Facsimile Services
Parcel delivery service (Domestic only).
* These services are available only during business hours.

Standard apartment layouts

(Some apartments may differ from the following.)

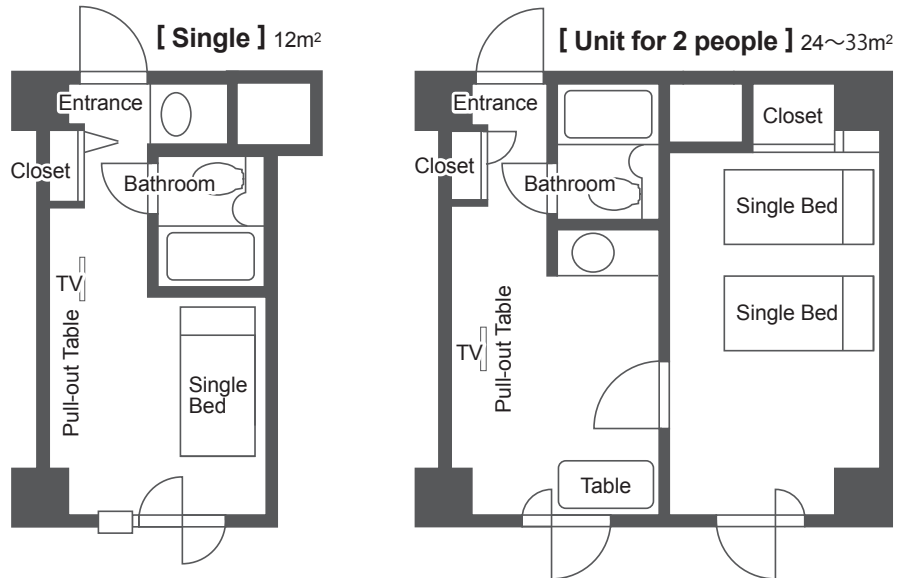

住所 : 〒174-0071 東京都板橋区常盤台1-52-5

電話 : 03-5392-5001

The nearest stations:

- 1) Tobu-tojo line, Tokiwadai station, North exit. 3-minute walk from the station.
- 2) Tobu-tojo line, Naka-itabashi station. 8-minute walk from the station.

From Narita Airport:

Take an Airport Limousine bus for "IKEBUKURO AREA HOTELS" and get off at the CROWNE PLAZA METROPOLITAN. ¥ 3,000/ one way. Traveling time is approx. 85 minutes, and then take Tobu-tojo line from Ikebukuro station to Tokiwadai station. ¥ 160/ one way. Traveling time is approx. 10 minutes. From Tokiwadai station to the WM Tokiwadai, it takes about 3 minutes by taxi. The taxi fee is approx. ¥ 660.

From Haneda Airport:

Take Keikyu Kuko Line Airport KAITOKU for "Narita Airport" and get off at Shinagawa station. ¥ 400/ one way. Traveling time is approx 17 minutes. Then take JR Yamanote line from Shinagawa station to Ikebukuro station. It takes about 30 minutes and costs ¥ 250/ one way. And then take Tobu tojo line from Ikebukuro station to Tokiwadai station. It takes about 10 minutes and costs ¥ 160/ one way. From the station to the WM Tokiwadai, it takes about 4 minutes on foot.

The information above is subject to change without notice