



WEEKLY MANSION SHIROGANE

20110719

Address: 5-10-15, Shirogane, Minato-ku, Tokyo, Japan 〒108-0072
Phone: 81-3-3443-1711/Fax: 81-3-3443-5394 (Business Hours are between 9 A.M. and 6 P.M.)

Reservations: Contact us at 81-3-3434-3939 (Tel) 81-3-3434-3927 (Fax)
For English, Please contact us between 9 A.M. and 6 P.M. from Mon to Fri.

■ On Site Pay Services:

- Coin laundries/Driers
- Vending machine (Beverages/ Newspaper)

■ In-Room Services and Amenities:

High-Speed Internet access/ Pay TV channels/
Telephone/ Mini-refrigerator
Air conditioner/ Bed (Exchange of sheets
and pillowcases is a chargeable service
and on request.)
Microwave
Table/ Kitcheware and Tableware
Bathroom/ Hairdrier

■ Business Services:

Copying and Facsimile Services
Delivery service (Domestic only).
* These services are available
only during business hours.

Standard apartment layouts

(Some apartments may differ from the following.)

[Single] 13m²

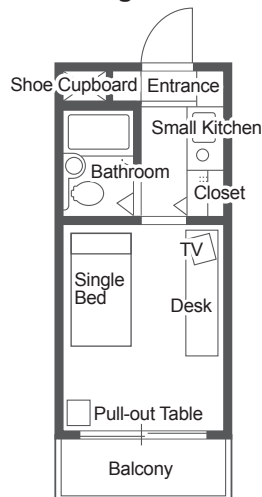

[Single] 13m²

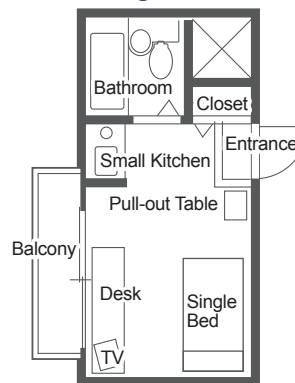

[Twin] 22m²

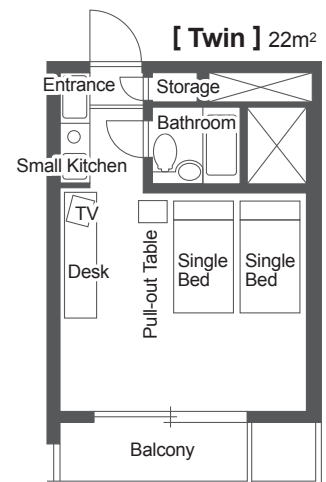

住所 : 〒108-0072 東京都港区白金5-10-15

電話 : 03-3443-1711

The nearest stations:

- 1) Subway Hibiya line, Hiroo station, #1 exit. 12-minute walk from the station.
- 2) Toei Bus, "Kitazato Kenkyujo Bus Stop". 2-minute walk from the station.
- 3) Subway Mita line, Nanboku line, Shiroganetakanawa station #3 exit. 15-minute walk from the station.

From Narita Airport:

Take an Airport Limousine bus for "SHINAGAWA/ EBISU AREA HOTELS" and get off at the SHERATON MIYAKO HOTEL TOKYO ¥3,000/ one way. Traveling time is approx. 85-110 minutes. From the the SHERATON MIYAKO HOTEL TOKYO to the WM Shirogane, it takes about 30 minutes on foot. If you take a taxi from the hotel, it takes about 10 minutes and the taxi fee is approx. ¥1,000.

From Haneda Airport:

Take Keikyu Kuko Line Airport KAITOKU for "Narita Airport" and get off at Shinagawa station. ¥400/ one way. Traveling time is approx. 17 minutes. And then take JR Yamanote line from Shinagawa station to Ebisu station. It takes about 10 minutes and costs ¥150/ one way. From the station to the WM Shirogane, it takes about 30 minutes on foot. If you take a taxi from the station, it takes about 10 minutes and the taxi fee is approx. ¥710

The information above is subject to change without notice

WEEKLY MANSION TOKYO URL: <http://www.wmt.co.jp/en/>