



WEEKLY MANSION SHINAGAWA

20120425

Address: 1-22-19, Kita-shinagawa, Shinagawa-ku, Tokyo, Japan 〒140-0001
Phone: 81-3-3458-4281/Fax: 81-3-3458-4290 (Business Hours are between 9 A.M. and 6 P.M.)

Reservations: Contact us at 81-3-3434-3939 (Tel) 81-3-6891-7711 (Fax)
For English, Please contact us between 9 A.M. and 6 P.M. from Mon to Fri.

■ On Site Pay Services:

- Coin laundries/Driers/ Coin Locker
- Vending machine (Beverages/ Newspaper)

■ In-Room Services and Amenities:

High-Speed Internet access/ TV
Video-on-Demand
Telephone/ Mini-refrigerator
Air conditioner/ Bed (Exchange of sheets and pillowcases is a chargeable service and on request.)
Microwave/ Table/ Kitchenware and Tableware/ Bathroom/ Hair drier/ Alarm clock

■ Business Services:

Copying and Facsimile Services
Parcel delivery service (Domestic only).
* These services are available only during business hours.

Standard apartment layouts

(Some apartments may differ from the following.)

[Single] 13m²

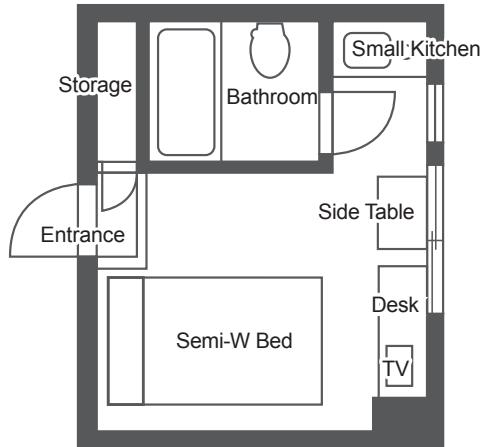

[Single] 13m²

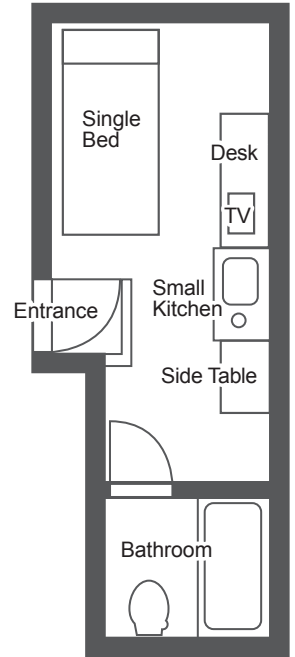

住所 : 〒140-0001 東京都品川区北品川1-22-19

電話 : 03-3458-4281

The nearest stations:

- 1) JR Shinagawa station, Takanawa exit. 10-minute walk from the station.
- 2) Keihin-kyuko line, Kita-shinagawa station. 1-minute walk from the station.

From Narita Airport:

Take the Narita Express for " TOKYO-SHINAGAWA-YOKOHAMA-OFUNA " and get off at the Shinagawa station. ¥ 3,110/ one way. Traveling time is approx. 90 minutes. From the station to the WM Shinagawa, it takes about 10 minutes on foot. If you take a taxi from the station, the taxi fee is approx. ¥ 660.

From Haneda Airport:

Take Keikyu Kuko Line KAITOKU for "Narita Airport" and get off at Keikyu Kamata station. And then take Keikyu Honsen for "Shinagawa" from Kamata station to Kitashinagawa station. ¥ 400/ one way. Traveling time is approx. 34 minutes. From the station to the WM Shinagawa, it takes about 2 minutes on foot.

The information above is subject to change without notice

WEEKLY MANSION TOKYO URL: <http://www.wmt.co.jp/en/>