



# WEEKLY MANSION SAKURAGICHO

20120430

Address: 2-72-16, Hanasaki-cho, Naka-ku, Yokohama-shi, Kanagawa, Japan 〒231-0063  
Phone: 81-45-262-5388/Fax:81-45-262-5389 (Business Hours are between 9 A.M. and 6 P.M.)

**Reservations:** Contact us at 81-3-3434-3939 (Tel) 81-3-6891-7711 (Fax)  
For English, Please contact us between 9 A.M. and 6 P.M. from Mon to Fri.

## ■ On Site Pay Services:

- Coin laundries/Driers
- Parking lots(Reservation required)
- Vending machine (Beverages/ Newspaper)

## ■ In-Room Services and Amenities:

- TV
- High-speed Internet access
- Video-on Demand
- Telephone/ Mini-refrigerator
- Air conditioner/ Bed (Exchange of sheets and pillowcases is a chargeable service and on request.)
- Table/ Kitchenware and
- Tableware/ Bathroom

## ■ Business Services:

- Copying and Facsimile Services
- Delivery service (Domestic only).
- \* These services are available only during business hours.

## Standard apartment layouts

(Some apartments may differ from the following.)

[ Single ] 10m<sup>2</sup>

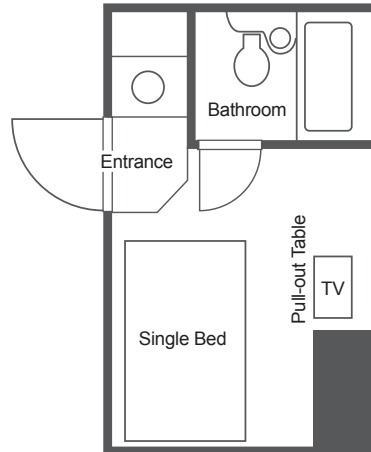

[ Single ] 12m<sup>2</sup>

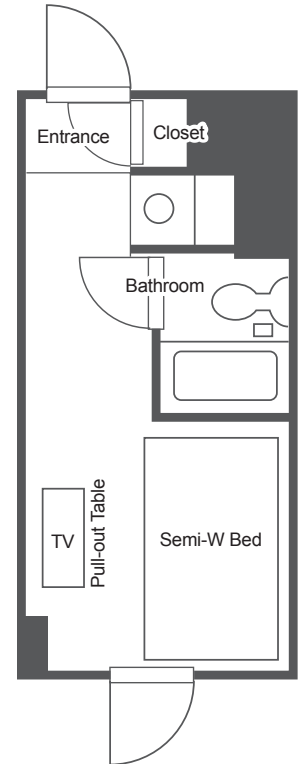

住所 : 〒231-0063 神奈川県横浜市中区花咲町2-72-16

電話 : 045-262-5388

## The nearest stations:

- 1) JR, Shiei-chikatetsu(Subway), Sakuragi-cho station. 5-minute walk from the station.
- 2) Keihin-Kyuko line, Hinode-cho station. 10-minute walk from the station.

## From Narita Airport:

Take an Narita Express for "OFUNA" and get off at Yokohama station. ¥4,180/ one way. Traveling time is approx. 110 minutes. And then take JR Keihin-Tohoku line from Yokohama station to Sakuragi-cho station. ¥130/ one way. Traveling time is approx. 3 minutes. From Yokohama station to the WM Hanasaki-cho, it takes about 5 minutes by taxi. The taxi fee is approx. ¥1,000.

## From Haneda Airport:

Take Keikyu Kuko Line Tokkyu for "Uruga" and get off at Yokohama station, it takes about 25 minutes and costs ¥470/one way. And then take JR Yokohama line from Yokohama station to Sakuragicho station. It takes about 5 mints and costs ¥130/ one way. From the station to the WM Sakuragi-cho, it takes about 5 minutes on foot.

The information above is subject to change without notice

WEEKLY MANSION TOKYO URL: <http://www.wmt.co.jp/en/>