



FLEXSTAY NIPPORI Inn

20120427

(Former WEEKLY MANSION NIPPORI)

Address: 5-43-7, Higashi nippori, Arakawa-ku, Tokyo, Japan 〒116-0014

Phone: 81-3-3891-2710/Fax: 81-3-3891-2707 (Business Hours are between 8 A.M. and 10 P.M.)

Reservations: Contact us at 81-3-3434-3939 (Tel) 81-3-6891-7711 (Fax)

For English, Please contact us between 9 A.M. and 6 P.M. from Mon to Fri.

■ On-Site Pay Services:

- Coin laundries/Driers
- Vending machine (Beverages/ Newspaper)

■ In-Room Services and Amenities:

High-Speed Internet access/ TV
 Video-on-Demand
 Telephone/ Mini-refrigerator
 Air conditioner/ Bed (Exchange of sheets and pillowcases is a chargeable service and on request.)
 Microwave/ Table/ Kitchenware and Tableware/ Bathroom/ Hair drier
 Electric kettle/ Alarm clock/ Western bathrobe
 Wash-toilet system

■ Business Services:

Copying and Facsimile Services
 Delivery service (Domestic only).
 * These services are available only during business hours.

Standard apartment layout

(Some apartments may differ from the following.)

[Single] 13m²

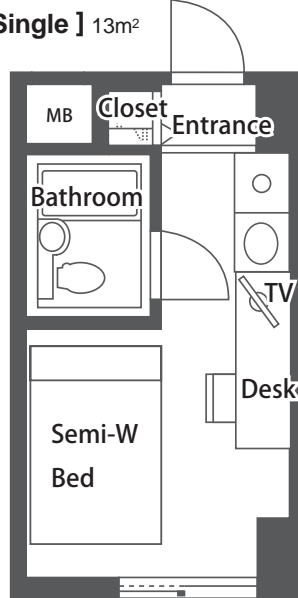

[Single] 13m²

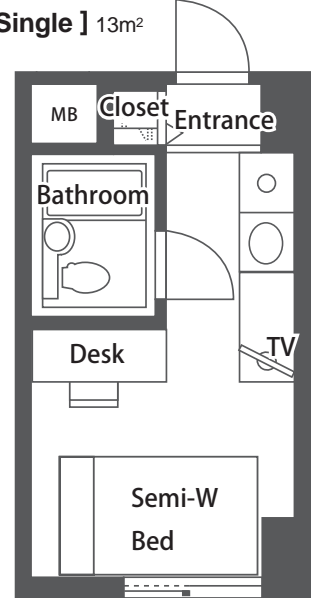

住所 : 〒116-0014 東京都荒川区東日暮里5-43-7

電話 : 03-3891-2710

The nearest station:

1) JR Yamanote line, Nippori station, South exit. 5-minute walk from the station.

From Narita Airport:

Take Keisei Sky Liner for "Keisei Ueno" and get off at Keisei Nippori station. ¥1,920/ one way. Traveling time is approx. 50 minutes. From Keisei Nippori station to the FS Nippori, it takes about 5 minutes on foot. If you take a taxi from the station, the taxi fee is approx. ¥710.

From Haneda Airport:

Take Tokyo Monorail Kaisoku for "Hamamatsucho" and get off at Hamamatsucho station. ¥ 470/ one way. Traveling time is approx. 17 minutes. And then take JR Yamanote Line for "Ueno, Ikebukuro" from Hamamatsucho station to Nippori station. Traveling time is approx. 16 minutes. ¥ 160/one way.
 From the station to the FS Nippori, it takes about 5 minutes on foot.

The information above is subject to change without notice

WEEKLY MANSION TOKYO URL: <http://www.wmt.co.jp/en/>