



WEEKLY MANSION NIHONBASHI

20110610

Address: 11-19, Tomizawa-cho, Nihonbashi, Chuo-ku, Tokyo, Japan 〒103-0006
Phone: 81-3-5649-0072/Fax: 81-3-5649-0076 (Business Hours are between 8 A.M. and 10 P.M.)

Reservations: Contact us at 81-3-3434-3939 (Tel) 81-3-3434-3927 (Fax)
For English, Please contact us between 9 A.M. and 6 P.M. from Mon to Fri.

■ On Site Pay Services:

- Coin laundries/Driers
- Parking lots
- Vending machine (Beverages/ Newspaper)
- Non-smoking apartments/ Exclusive apartments for women

■ In-Room Services and Amenities:

High-Speed Internet access/ TV
Microwave / Pay TV channels
Telephone/ Mini-refrigerator
Air conditioner/ Bed (Exchange of sheets and pillowcases is a chargeable service and on request.)
Table/ Kitchenware and Tableware
Bathroom/ Hairdrier

■ Business Services:

Copying and Facsimile Services
Delivery service (Domestic only).
* These services are available only during business hours.

Standard apartment layout

(Some apartments may differ from the following.)

[Single] 17m²

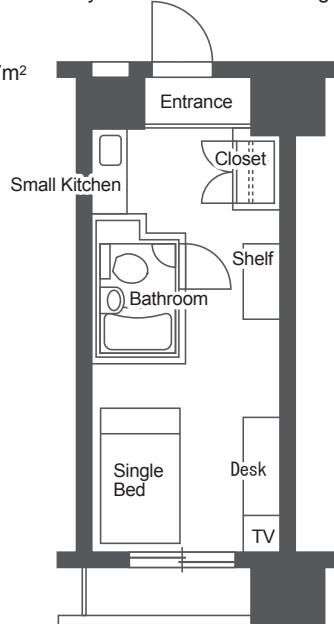

住所：〒103-0006 東京都中央区日本橋富沢町11-19

電話：03-5649-0072

The nearest stations:

- 1) Subway Hibiya line, Kodanma-cho #1 exit, Ningo-cho station, A4 exit. 4-minute walk from both.
- 2) Toei Asakusa line, Ningo-cho station A4 exit, Higashi nihonbashi station A3 exit. 4-minute walk from both.
- 3) Toei Shinjuku line, Bakurouyokoyama station A3 exit. 4-minute walk from the station.

From Narita Airport:

Take an Airport Limousine bus for " TOKYO CITY AIR TERMINAL " and get off at "T-CAT" . ¥ 2,900/ one way. Traveling time is approx. 55 minutes. From T-CAT to the WM Nihonbashi, it takes about 10 minutes and costs approx. ¥ 840 by taxi.

From Haneda Airport:

Take Keikyu Kuko Line Airport KYUKO for "Narita Airport" and get off at Ningocho station. ¥ 590/ one way. Traveling time is approx. 45 minutes. From the station to the WM Nihonbashi, it takes about 5 minutes on foot.

The information above is subject to change without notice

WEEKLY MANSION TOKYO URL: <http://www.wmt.co.jp/en/>