



WEEKLY MANSION NAKANOBU

20110929

Address: 4-27-8, Futaba, Shinagawa-ku, Tokyo, Japan 〒142-0043
Phone: 81-3-3788-1200/Fax: 81-3-3788-4116 (Business Hours are between 9 A.M. and 6 P.M.)

Reservations: Contact us at 81-3-3434-3939 (Tel) 81-3-3434-3927 (Fax)
For English, Please contact us between 9 A.M. and 6 P.M. from Mon to Fri.

■ On-Site Pay Services:

- Coin laundries/Driers
- Vending machine (Beverages/ Newspaper)

■ In-Room Services and Amenities:

High-Speed Internet access/ TV
Video-on Demand/ Telephone/ Mini-refrigerator
Air conditioner/ Bed (Exchange of sheets and pillowcases is a chargeable service and on request.)
Table/ Kitchenware and
Tableware/ Bathroom/ Hair drier(P2 only)

■ Business Services:

Copying and Facsimile Services
Parcel delivery service (Domestic only).
* These services are available only during business hours.

Standard apartment layouts

(Some apartments may differ from the following.)

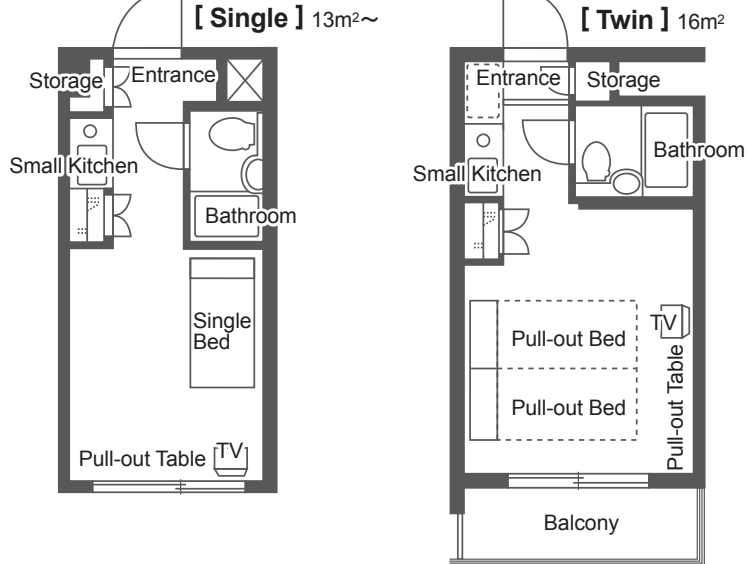

住所 : 〒142-0043 東京都品川区二葉4-27-8

電話 : 03-3788-1200

The nearest stations:

- 1) Toei Asakusa line, Nakanobu station, A1 exit. 5-minute walk from the station.
- 2) JR Yokosuka line, Nishi-oi station. 8-minute walk from the station.

From Narita Airport:

Take an Airport Limousine bus for "SHINAGAWA・EBISU AREA HOTELS" and get off at the SHINAGAWA PRINCE Hotel. ¥3,000/ one way. Traveling time is approx. 85-110 minutes. From the SHINAGAWA PRINCE hotel to the WM Nakanobu, it takes about 20 minutes by taxi. The taxi fee is approx. ¥1,300.

From Narita Airport:

Take Keikyu Kuko Line Airport KAITOKU for "Narita Airport" and get off at Sengakuji station. And then take Toei Asakusa line for "Magome" from Sengakuji station to Nakanobu station. ¥590/ one way. Traveling time is approx. 40 minutes. From the station to the WM Nakanobu, It takes about 5 minutes on foot.

The information above is subject to change without notice