



WEEKLY MANSION KAWASAKI-OGAWACHO

20120430

Address: 15-9, Ogawa-cho, Kawasaki-ku, Kawasaki-shi, Kanagawa, Japan 〒210-0023
Phone: 81-44-245-9660/Fax: 81-44-245-9661 (Business Hours are between 9 A.M. and 6 P.M.)

Reservations: Contact us at 81-3-3434-3939 (Tel) 81-3-6891-7711 (Fax)
For English, Please contact us between 9 A.M. and 6 P.M. from Mon to Fri.

■ On Site Pay Services:

- Coin laundries/Driers
- Vending machine (Beverages/ Newspaper)

■ In-Room Services and Amenities:

High-speed Internet access/ TV
Video-on Demand/ Microwave/ Electric pot
Telephone/ Mini-refrigerator
Air conditioner/ Bed (Exchange of sheets and pillowcases is a chargeable service and on request.)
Table/ Kitchenware and Tableware/ Bathroom/ Hair drier

■ Business Services:

Copying and Facsimile Services
Delivery service (Domestic only).

* These services are available only during business hours.

Standard apartment layout

(Some apartments may differ from the following.)

[Single] 9m²

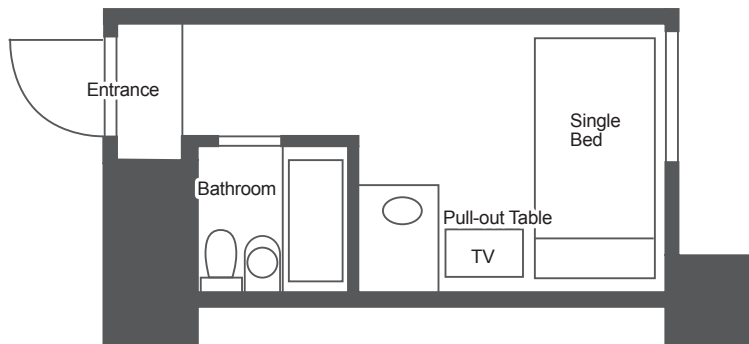

住所 : 〒210-0023 神奈川県川崎市川崎区小川町15-9

電話 : 044-245-9660

The nearest station:

1) JR Tokaido line or JR Keihintohoku line line, Kawasaki station, East exit. 5-minute walk from the station.

From Narita Airport:

Take Keisei Sky Liner for "Keisei Ueno" and get off at Keisei Nippori station. ¥1,920/ one way.
Traveling time is approx. 50 minutes. And then take JR Yamanote line for 「Tokyo」, get off at Tokyo station, transfer to JR Tokaidohansen for "Yokohama" and then get off at Kawasaki station. ¥380/ one way.
Traveling time is approx 30 minutes. If you take a taxi from Kawasaki station, the taxi fee is approx. ¥710.

From Haneda Airport:

Take Keikyu Kuko Line Tokkyu for "Uruga" and get off at Keikyu Kawasaki station, it takes about 15 minutes and costs ¥400/one way.
From the station to the WM Kawasaki-Ogawacho, it takes about 12 minutes on foot.

The information above is subject to change without notice