



WEEKLY MANSION ASAKUSA

Address: 1-21-11, Honjo, Sumida-ku, Tokyo, Japan 〒130-0004
Phone: 81-3-3626-2443/Fax: 81-3-3626-5322 (Business Hours are between 9 A.M. and 6 P.M.)

Reservations: Contact us at 81-3-3434-3939 (Tel) 81-3-6891-7711 (Fax)
For English, Please contact us between 9 A.M. and 6 P.M. from Mon to Fri.

■ On Site Pay Services:

- Coin laundries/ Driers
- Parking lots
- Vending machine (Beverages/ Newspaper)
- Rental bicycles
- Coin-Op Internet

■ In-Room Services and Amenities:

High-Speed Internet access/ TV/ Pay TV channels
Microwave/ Telephone/ Mini-refrigerator
Air conditioner/ Bed (Exchange of sheets and pillowcases is a chargeable service and on request.)
Table/ Kitchenware and Table ware
Bathroom/ Hairdrier

■ Business Services:

Copying and Facsimile Services
Delivery service (Domestic only).
* These services are available only during business hours.

Standard apartment layouts

(Some apartments may differ from the following.)

[Single] 12m²

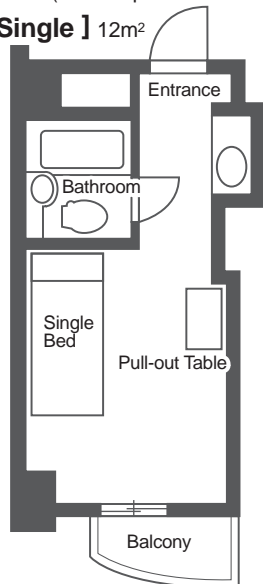

[Triple] 25m²

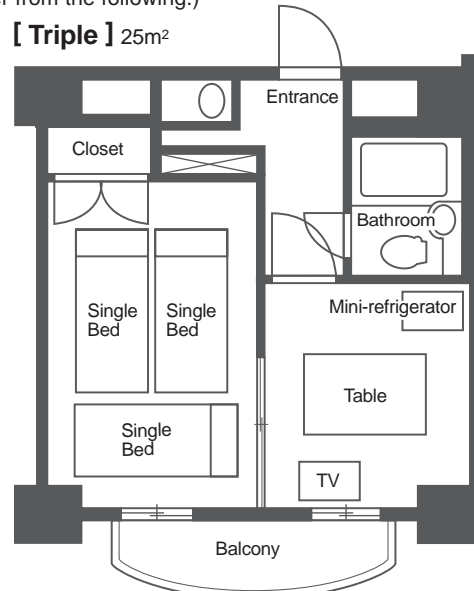

住所 : 〒130-0004 東京都墨田区本所1-21-10

電話 : 03-3626-2443

The nearest stations:

- 1) Toei Oedo line, Kuramae station, A7 exit. 4-minute walk from the station.
- 2) Toei Asakusa line, Kuramae station, A4 exit. 9-minute walk from the station.
- 3) JR Sobu line, Ryogoku station, East exit. 15-minute walk from the station.

From Narita Airport:

Take Keisei honsen super express for "Haneda Airport" or "Nishi Magome" from Terminal 2 and get off at Kuramae station. ¥1060/ one way. Traveling time is approx. 90 minutes. From the station to the WM Asakusa, it takes about 7 minutes on foot.

From Haneda Airport:

Take Keikyu Kuko Line Airport KAITOKU for "Narita Airport" and get off at Kuramae station. ¥590/ one way. Traveling time is approx. 41 minutes. From the station to the WM Asakusa, it takes about 7 minutes on foot.

The information above is subject to change without notice