



Weekly Mansion Akasaka

20101009

Address: 2-17-54, Akasaka, Minato-ku, Tokyo, Japan 〒107-0052

Phone: 81-3-5570-0230 / Fax: 81-3-5570-0233 (Business Hours are between 7 A.M. and Midnight)

Reservations: Contact us at 81-3-3434-3939 (Tel) 81-3-3434-3927 (Fax)

For English, Please contact us between 9 A.M. and 6 P.M. from Mon to Fri.

■ On Site Pay Services:

- Coin laundries/Driers
- Parking lots
- Vending machine (Beverages/ Newspaper)
- Coin-Op Internet

■ In-Room Services and Amenities:

High-Speed Internet access/ TV / Pay TV channels
Telephone/ Mini-refrigerator
Air conditioner/ Bed (Exchange of sheets and pillowcases is a chargeable service and on request.)
Table / Kitchenware and Tableware/ Hair drier/ Alarm clock

■ Business Services:

Copying and Facsimile Services
Delivery service (Domestic only).
* These services are available only during business hours.

Standard apartment layouts

(Some apartments may differ from the following.)

[Single] 24m²

[Twin] 35m²

[Triple] 38m²

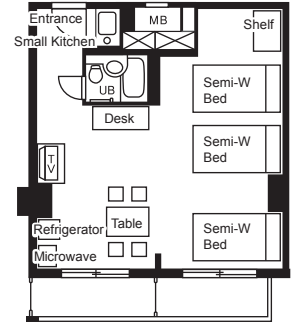
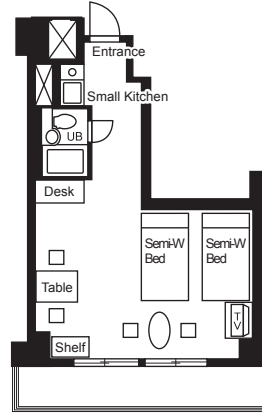
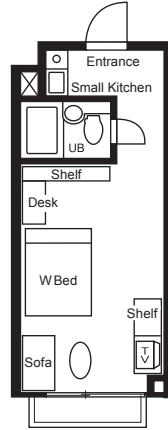

住所 : 〒107-0052 東京都港区赤坂2-17-54

電話 : 03-5570-0230

The nearest stations:

- 1) Subway Chiyoda line, Akasaka station, 5a・5b exit. 3-minute walk from the station.
- 2) Subway Ginza line, Tameikesanno station, 12 exit. 8-minute walk from the station.
- 3) Subway Marunouchi line, Akasakamitsuke station. 15-minute walk from the station.

From Narita Airport:

Take an Airport Limousine bus for "AKASAKA AREA HOTELS" and get off at the ANA Intercontinental Tokyo. ¥3,000/ one way.

Traveling time is approx.80-120 minutes.From the ANA Intercontinental Tokyo to the WM Akasaka,it takes about 10 minutes on foot.

If you take a taxi from the hotel, the taxi fee is approx. ¥680.

From Haneda Airport:

Take Tokyo Monorail Kaisoku for "Hamamatsucho" and get off at Hamamatsucho station. ¥470/ one way.

Traveling time is approx. 17 minutes. And then take JR Yamanote Line for "Ueno, Ikebukuro" from Hamamatsucho station to Shinbashi station. Traveling time is approx.2 minutes. ¥130/one way. And then take Tokyo Metro Ginza Line for "Shibuya" from Shinbashi Station to Tameikesanno Station. Traveling time is approx.5 minutes. ¥160/one way.

From the station to the WM Akasaka, it takes about 8 minutes on foot.

The information above is subject to change without notice

WEEKLY MANSION TOKYO URL: <http://www.wmt.co.jp/en/>